

**MUNICIPALITY OF MIDDLESEX CENTRE**

**BYLAW NUMBER 2017-032**

**BEING A BY-LAW TO AMEND THE MIDDLESEX CENTRE  
COMPREHENSIVE ZONING BY-LAW NUMBER 2005-005  
WITH RESPECT TO PART OF LOT 6, CONCESSION 11  
(GEOGRAPHIC TOWNSHIP OF LOBO)  
ROLL NUMBER: 393900003018700**

**WHEREAS** the Council of the Municipality of Middlesex Centre deems it advisable to amend the Middlesex Centre Comprehensive Zoning By-law 2005-005;

**AND WHEREAS** this By-law is in conformity with the Middlesex Centre Official Plan;

**THEREFORE** the Council of the Municipality of Middlesex Centre enacts as follows:

1. That Zoning Map Schedule 'A', Key Map 16 to the Middlesex Centre Comprehensive Zoning By-law 2005-005, is hereby amended by changing from the Agricultural (A1) zone to the Surplus Residence (SR) zone and the Agricultural – No Residences (A3) zone that land drawn in heavy solid lines and identified on Schedule 'A', attached hereto and described as being Part of Lot 6, Concession 11 (geographic Township of Lobo), Municipality of Middlesex Centre.
2. This by-law comes into force and takes effect upon the day of passing in accordance with the provisions of Section 34 of the Planning Act, R.S.O 1990, c. P.13.

**READ A FIRST, SECOND AND THIRD TIME, AND FINALLY PASSED** this 22nd day of February, 2017.

\_\_\_\_\_  
Mayor

\_\_\_\_\_  
Clerk

# MUNICIPALITY OF MIDDLESEX CENTRE

## SCHEDULE 'A'

SEE MAP 2

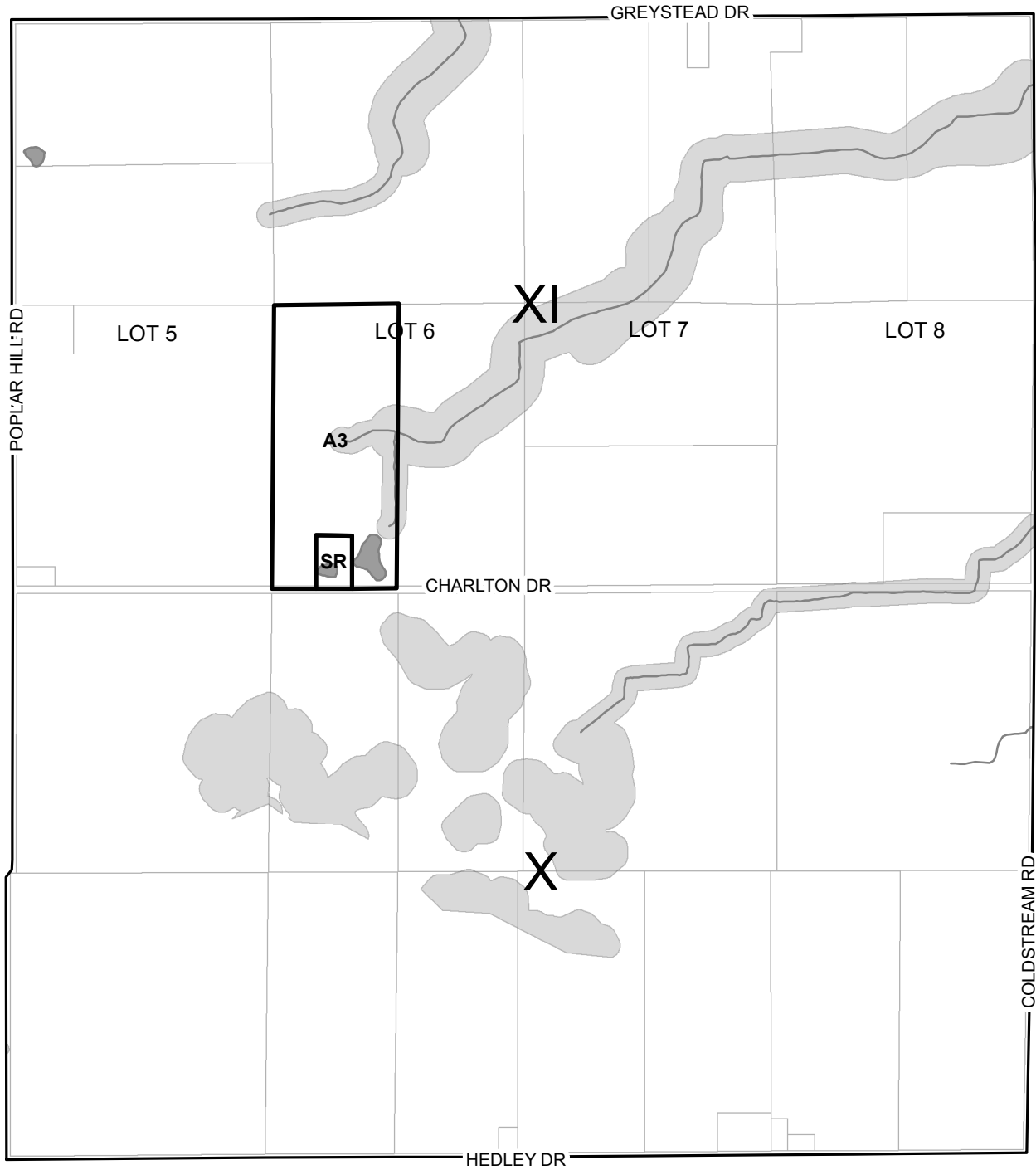

SEE MAP 15

SEE MAP 17

SEE MAP 30

NOTE: Schedules should be read in conjunction with applicable provisions of the Zoning By-Law.

SCALE 1:15,000

